

Figure 447. Transmission Power Takeoff Assembly and Mounting Hardware.

| ITEM NO | SMR CODE | CAGEC | PART NUMBER | DESCRIPTION AND USABLE ON CODES(UOC) | QTY |
|--|----------|-------|----------------|--|-----|
| GROUP 2004 POWER TAKEOFF ASSEMBLY | | | | | |
| FIG. 447 TRANSMISSION POWER TAKEOFF ASSEMBLY AND MOUNTING HARDWARE | | | | | |
| 1 | PAFFH | 19207 | 7409589 | POWER TAKEOFF,TRANS UOC:620,627,633 | 1 |
| 2 | PAFZZ | 24617 | 713421 | BEARING UOC:620,627,633 | 1 |
| 3 | PAFZZ | 96906 | MS35756-109 | KEY,WOODRUFF UOC:620,627,633 | 1 |
| 4 | PAFZZ | 19207 | 7409594 | SHAFT REVERSE GEAR UOC:620,627,633 | 1 |
| 5 | XAFZZ | 19207 | 10900574 | SHAFT UOC:620,627,633 | 1 |
| 6 | PAFZZ | 19207 | 7373115 | BEARING,SLEEVE UOC:620,627,633 | 1 |
| 7 | PAFZZ | 19207 | 7061281 | WASHER,THRUST UOC:620,627,633 | 2 |
| 8 | PAFZZ | 96906 | MS24665-281 | PIN,COTTER UOC:620,627,633 | 1 |
| 9 | PAFZZ | 19207 | 7409587 | GEAR REVERSE SHAFT UOC:620,627,633 | 1 |
| 10 | PAFZZ | 19207 | 8728251 | PIN,STRAIGHT,HEADED UOC:620,627,633 | 1 |
| 11 | PAFZZ | 96906 | MS90728-29 | BOLT,MACHINE UOC:620,627,633 | 2 |
| 12 | PAFZZ | 81348 | WW-P-471ACABCA | PLUG,PIPE UOC:620,627,633 | 1 |
| 13 | PAFZZ | 96906 | MS17131-35 | BEARING,ROLLER,NEED UOC:620,627,633 | 1 |
| 14 | PAFZZ | 95019 | 9P21 | SHAFT,SHOULDERED UOC:620,627,633 | 1 |
| 15 | PAFZZ | 96906 | MS24665-497 | PIN,COTTER UOC:620,627,633 | 1 |
| 16 | PAFZZ | 19207 | 7538656 | WASHER,KEY UOC:620,627,633 | 2 |
| 17 | PAFZZ | 19207 | 7538658 | ROLLER ASSEMBLY,JOU UOC:620,627,633 | 2 |
| 18 | PAFZZ | 19207 | 7409586 | GEAR CLUSTER UOC:620,627,633 | 1 |
| 19 | PFFZZ | 19207 | 7061160 | HOUSING,POWER TAKEO UOC:620,627,633 | 1 |
| 20 | PAFZZ | 81348 | 111X03502K0000 | BEARING,BALL,ANNULA UOC:620,627,633 | 1 |
| 21 | PAFZZ | 19207 | 7061265 | SPACER POWER TAKE O UOC:620,627,633 | 1 |
| 22 | PAFZZ | 19207 | 5226140 | RETAINER,SHIFTER SH UOC:620,627,633 | 1 |
| 23 | PAFZZ | 19207 | 8331558 | SPRING,HELICAL,COMP UOC:620,627,633 | 1 |
| 24 | PAFZZ | 96906 | MS19059-2422 | BALL,BEARING | 1 |

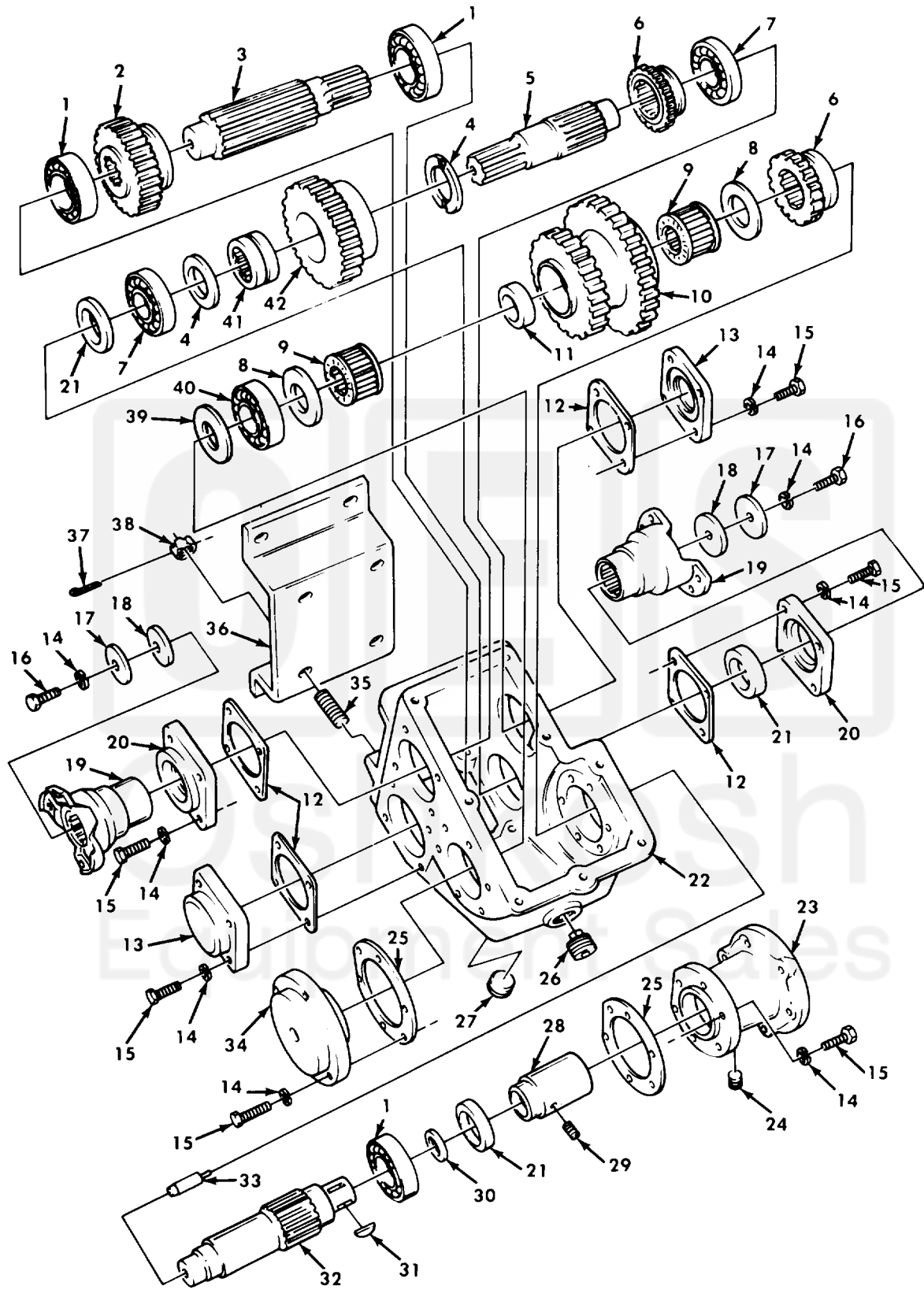

Figure 452. Power Divider Gears, Yokes, and Related Parts.

SECTION II TM9-2320-260-34P-2
 (1) (2) (3) (4) (5) (6)
 Current part is item (40,20) on diagram. Available at www.oshkoshequipment.com

| ITEM NO | SMR CODE | CAGEC | PART NUMBER | DESCRIPTION AND USABLE ON CODES(UOC) | QTY |
|---------|----------|-------|----------------|--------------------------------------|-----|
| 25 | PAFZZ | 19207 | 7414252 | UOC:622 GASKET | 2 |
| 26 | PAOZZ | 96906 | MS49006-10 | UOC:622 PLUG,PIPE,MAGNETIC | 1 |
| 27 | PAOZZ | 21450 | 444673 | UOC:622 PLUG,PIPE | 1 |
| 28 | PAFZZ | 19207 | 7413947 | UOC:622 COUPLING,SHAFT,RIGI | 1 |
| 29 | PAFZZ | 96906 | 223088 | UOC:622 SETScrew | 1 |
| 30 | PAFZZ | 19207 | 8333868 | UOC:622 SEAL,NONMETALLIC ST | 1 |
| 31 | PAFZZ | 96906 | MS35756-22 | UOC:622 KEY,WOODRUFF | 1 |
| 32 | PAFZZ | 19207 | 7414261 | UOC:622 SHAFT,SHOULDERED | 1 |
| 33 | PAFZZ | 19207 | 7414257 | UOC:622 PIN,STRAIGHT,HEADLE | 1 |
| 34 | PAFZZ | 19207 | 7413943 | UOC:622 ADAPTER,GOVERNOR | 1 |
| 35 | PAFZZ | 19207 | 10900283 | UOC:622 STUD,PLAIN | 4 |
| 36 | PPFZZ | 19207 | 10876386 | UOC:622 BRACKETT,DOUBLE ANGL | 1 |
| 37 | PAFZZ | 96906 | MS24665-421 | UOC:622 PIN,COTTER | 4 |
| 38 | PAFZZ | 96906 | MS35692-53 | UOC:622 NUT,PLAIN,SLOTTED,H | 4 |
| 39 | PAFZZ | 96906 | MS51000-116-2 | UOC:622 SEAL,PLAIN ENCASED | 1 |
| 40 | PAFZZ | 81348 | 111X03502X0000 | UOC:622 BEARING BALL,ANNULA | 1 |
| 41 | PAFZZ | 96906 | MS51961-28 | UOC:622 BEARING,ROLLER,NEED | 1 |
| 42 | PAFZZ | 19207 | 7414254 | UOC:622 GEAR,SPUR | 1 |

END OF FIGURE

Current part is item (40,20) on diagram. Available at www.oshkoshequipment.com